

Custom Wood Frame Overlay for Glass Doors Installation Instructions

Wine Cellars

6SWC

6SWCE

61WC

61WCM

66SWC (2 required)

66SWCE (2 required)

Beverage Centers

6SBAR

6SBARE

6BAR

6BARM

66SWBE (2 required)

66SBWE (2 required)

66WBM (2 required)

66BWM (2 required)



life. luxury. marvel.

An AGA Company

CUSTOM WOOD FRAME INSTALLATION INSTRUCTIONS

STEP 1: WOOD SCREWS REQUIRED

1. A #8 pan head wood screw should be used to properly secure the wood frame. A total of 10 screws will be needed for a 3 1/2 inch toe kick or 8 screws for a 4 inch toe kick.
2. Use only pan head screws.
3. DO NOT select a screw that is longer than the wood thickness at the screw locations.
4. Use recommended pilot holes for the frame material (see Table A below).

Table A: Pilot Hole Drill Sizes For Wood Screw

Work Material	Wood Screw Size
	8
Hardwood	3/32
Softwood	5/64

STEP 2: ASSEMBLING DOOR HINGE BRACKETS

Disregard if hinges are already attached.

1. Attach the top and bottom door hinge bushing brackets to the door with the 1/4-20 machine screws and a 5/32 inch Allen head driver as shown in Figure 1.
2. Press in the shoulder bushings to the top and bottom door hinges. Make certain that the shoulder is to the outside of the door as shown in Figure 1.
3. Test fit the door to the unit to make certain door will hang correctly. The door is hung correctly when the top of the door is parallel to the top of the unit. Adjustments can be made by loosening the door hinge machine screws and moving the door hinge on the door.
4. Tighten all four machine screws after adjustments have been made.
5. Remove the door from the unit by removing the unit's top hinge set screw and angling the door off of the bottom hinge pin.

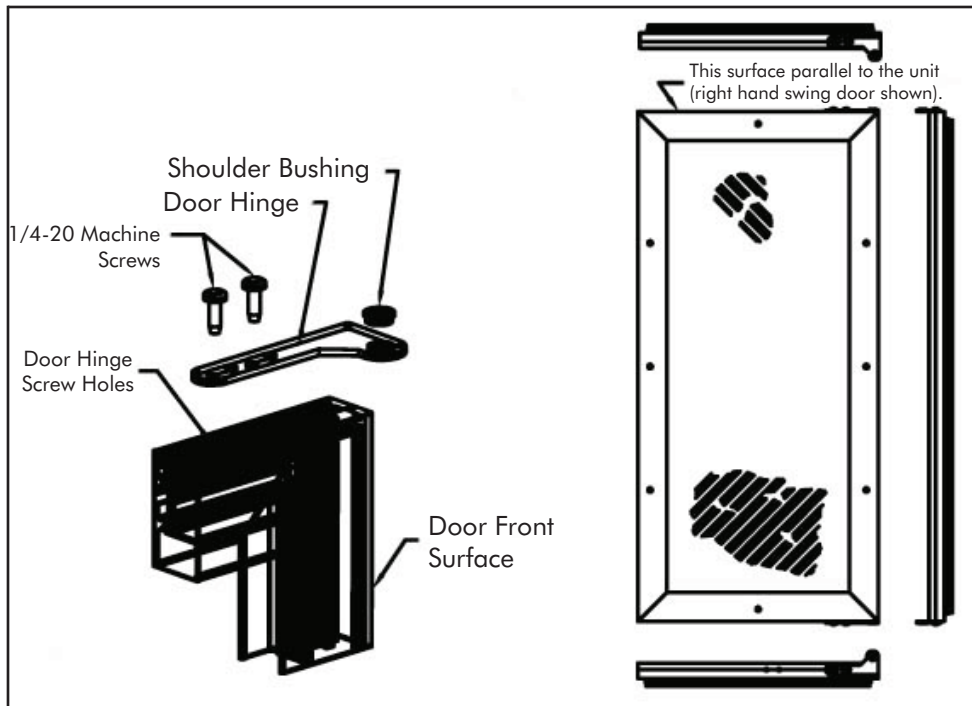

Figure 1: Typical Top and Bottom Door Hinge Assembly

CUSTOM WOOD FRAME INSTALLATION INSTRUCTIONS

STEP 3: SELECTING AND PREPARING THE WOOD FRAME

For a 3.5 inch Toe Kick
(Covers the Entire Door Extrusion)

Optional for a 4 inch Toe Kick
(To Match Existing Cabinetry
Toe Kick Height)

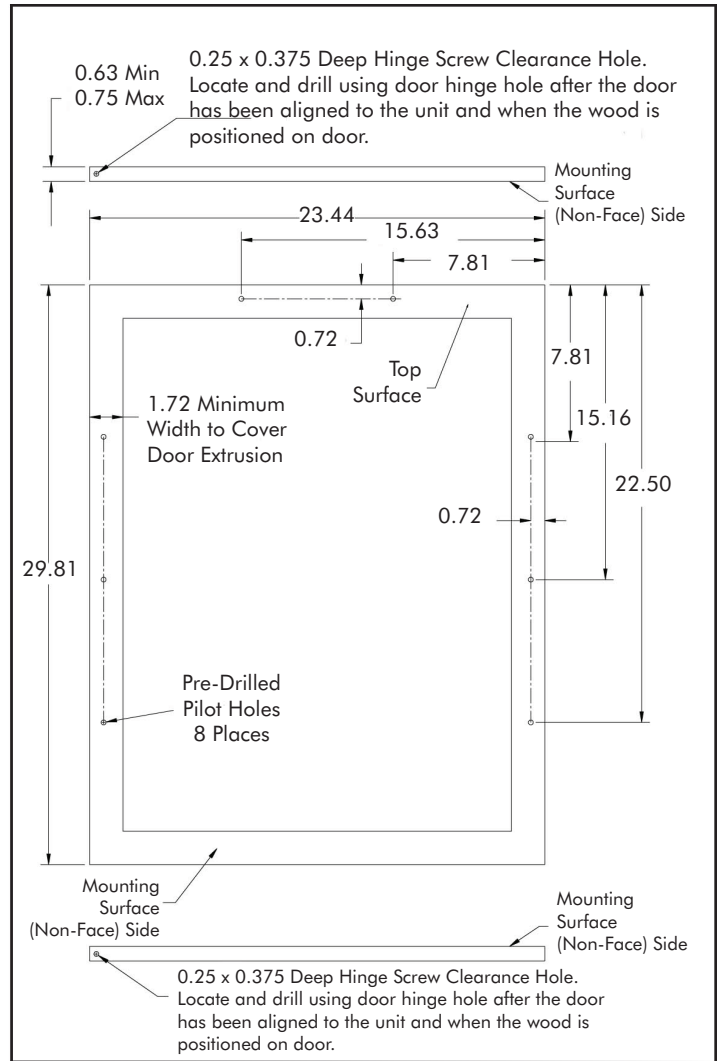
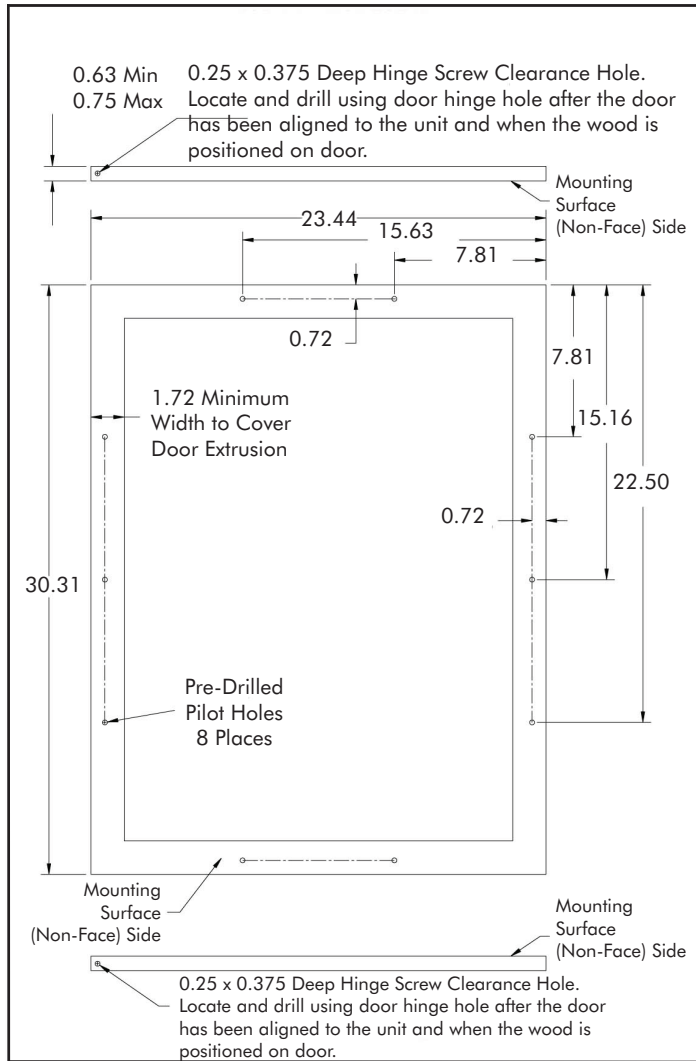

OPTIONAL LOCK AND KEY

The optional lock and key helps protect your contents from tampering or misuse. The lock and key kit contains a lock cylinder, catch bracket, keys, and an installation nut. Some assembly is required as the lock and key is installed on the front of the wood frame. See Figures 2 and 3 above for lock and key installation dimensions.

CUSTOM WOOD FRAME INSTALLATION INSTRUCTIONS

STEP 4: DETERMINING DOOR SWING

The door you received is for a right hand swing unit. If the unit is to be changed to a left hand swing door, pre-drilled striker plate holes are in place on the backside of the door on both ends. No additional drilling is necessary to mount the striker plate when you reverse the door swing. Just unscrew the striker plate from the location it is mounted to for right hand swing and then mount the striker plate at the end opposite of its previous location with the existing screws.

If your door has an inner door liner with formed in shelves, it will need to be turned around for use in the left hand swing. Using a small, flat blade screwdriver, pop the plastic screw covers up to access the Phillips screws that secure the formed door liner to the door. Using a Phillips screwdriver, remove the Phillips screws that secure the formed door liner to the door. Rotate the formed door liner 180 degrees, line up the mounting holes in the door liner with the mounting holes on the door. Use the existing fasteners and plastic screw caps to secure the formed door liner to the door. Your door swing conversion is complete.

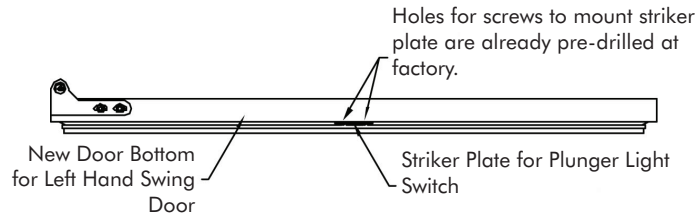

Figure 4: Striker Plate Hole Location

Remove the nameplate for the glass door by gently pulling it up and away from the glass surface. Relocate the nameplate using the supplied nameplate locator (part number: 41006022).

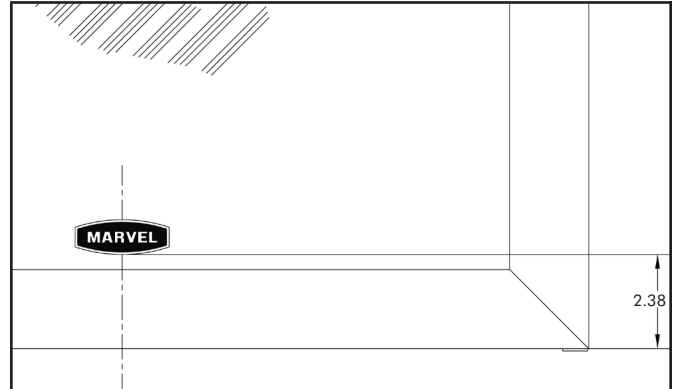

Figure 5: Nameplate Locator

CUSTOM WOOD FRAME INSTALLATION INSTRUCTIONS

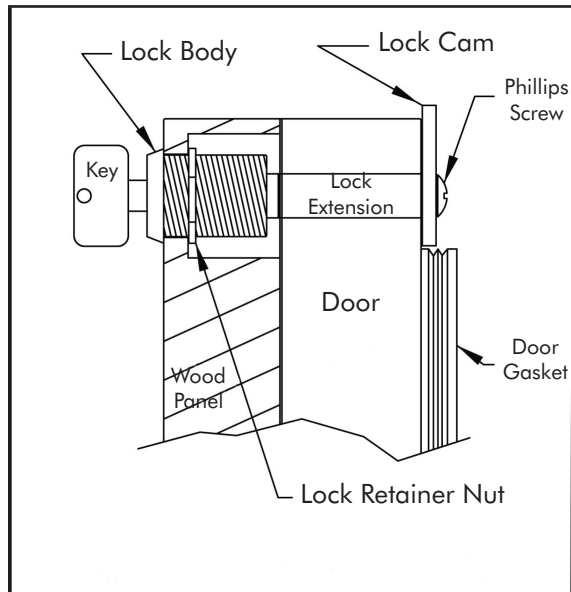

Figure 6: Lock Installation Detail

NOTE: Two (2) brass lock extensions are supplied with the Marvel Door Lock. The longer one is for 3/4 inch thick panels, and the shorter one is for 5/8 inch thick panels.

STEP 5: ATTACHING THE OVERLAY PANEL TO THE DOOR (WITH THE LOCK AND KEY FEATURE)

1. If the door is attached to the unit, remove it by unscrewing the top Allen head set screw at the top hinge. Remove the door by angling the door off of the bottom hinge pin.
2. Install the supplied lock body into the wood panel. The lock and key assembly is supplied with your unit. Secure the lock body by using the supplied 15mm lock retaining nut and screwing it on the lock body's threaded section. Make sure that the lock's set slot is vertical, then tighten the 15mm nut with a 15mm deep well socket.
3. Peel back door gasket to provide access to the screw holes used to mount the wood frame and the hole for the lock's extension section at the top of the door.
4. Set the wood frame flush to the front of the door in the desired location. Clamp wood frame to the door if necessary. Check to see that the back of the lock in the wood frame lines up with the hole in the door.
5. Insert the wood screws through the back of the door into the pilot holes in the wood frame and tighten.
6. Assemble the door lock's Phillips screw, lock extension and lock cam and mount them to the back of the lock body. The cam is to be oriented vertically, then tighten the Phillips screw to secure the lock assembly.
7. Reinstall the door gasket by pressing into door channel. Make certain the corners are inserted fully. Insert the key into the lock and make sure the lock operates properly.
8. Install the door to the unit. Use the supplied plastic washers as shown in Figure 7.
9. Realigning the door may be necessary. Any final door adjustments can be made using a 1/8 inch Allen head driver to adjust the door's hinges (see Figure 7).
10. Attach the door light striker plate as shown using the 5/16 inch Hex or Phillips head screws provided. Make certain the light is able to turn on and off when the door is opened and closed.
11. Attach the door to the unit by reversing steps number 1 above.
12. Insert the key into the lock and verify that the lock cam works properly with the catch bracket on the cabinet front.

CUSTOM WOOD FRAME INSTALLATION INSTRUCTIONS

STEP 5: ATTACHING THE WOOD FRAME TO THE DOOR (WITHOUT THE LOCK AND KEY FEATURE)

1. If the door is attached to the unit, remove it by unscrewing the top Allen head set screw at the top hinge. Remove the door by angling the door off of the bottom hinge pin.
2. Peel back door gasket to expose the screw holes.
3. Set the wood frame flush to the front of the door in the desired location. Clamp wood frame to the door if necessary.
4. Insert the wood screws through the back of the door into the pilot holes in the overlay panel and tighten.
5. Reinstall door gasket by pressing into door channel.
6. Install the door to the unit. Use the supplied plastic washers as shown in Figure 7.
7. Realigning the door may be necessary. Any final door adjustments can be made using a 5/32 inch Allen head driver to adjust the door's hinges (see Figure 7).
8. Attach the door light striker plate as shown using the Hex or Phillips head screws provided. Make certain the light is able to turn on and off when the door is opened and closed.
9. Attach the door to the unit by reversing step number 1 above.

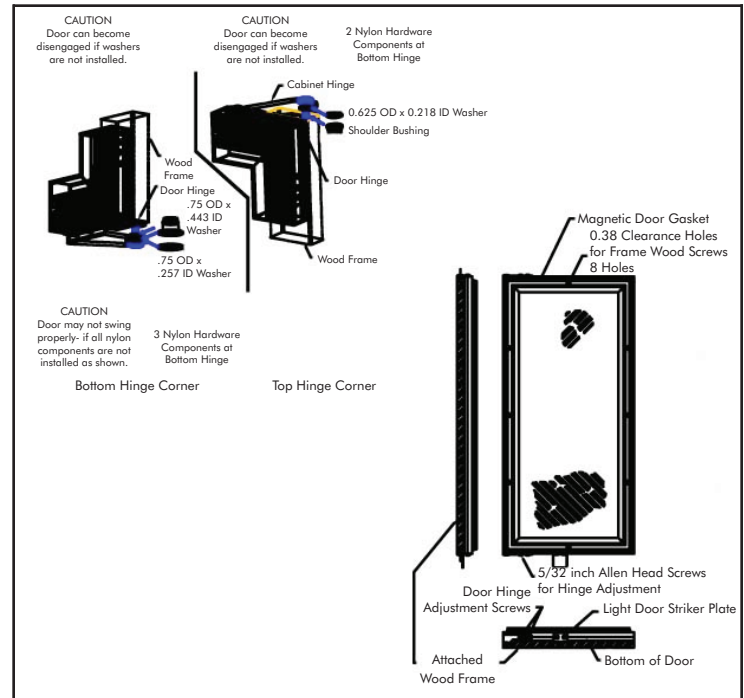

Figure 7: Hinge Hardware Installation Details



www.lifeluxurymarvel.com

Marvel Industries
P.O. Box 997
Richmond, IN
47375-0997

800.428.6644

An AGA Company

41006981 Rev F
10.30.07

All specifications and product designs subject to change without notice. Such revisions do not entitle the buyer to corresponding changes, improvements, additions, replacements or compensation for previously purchased products.